

TS7000IMP Series Rotary Valve

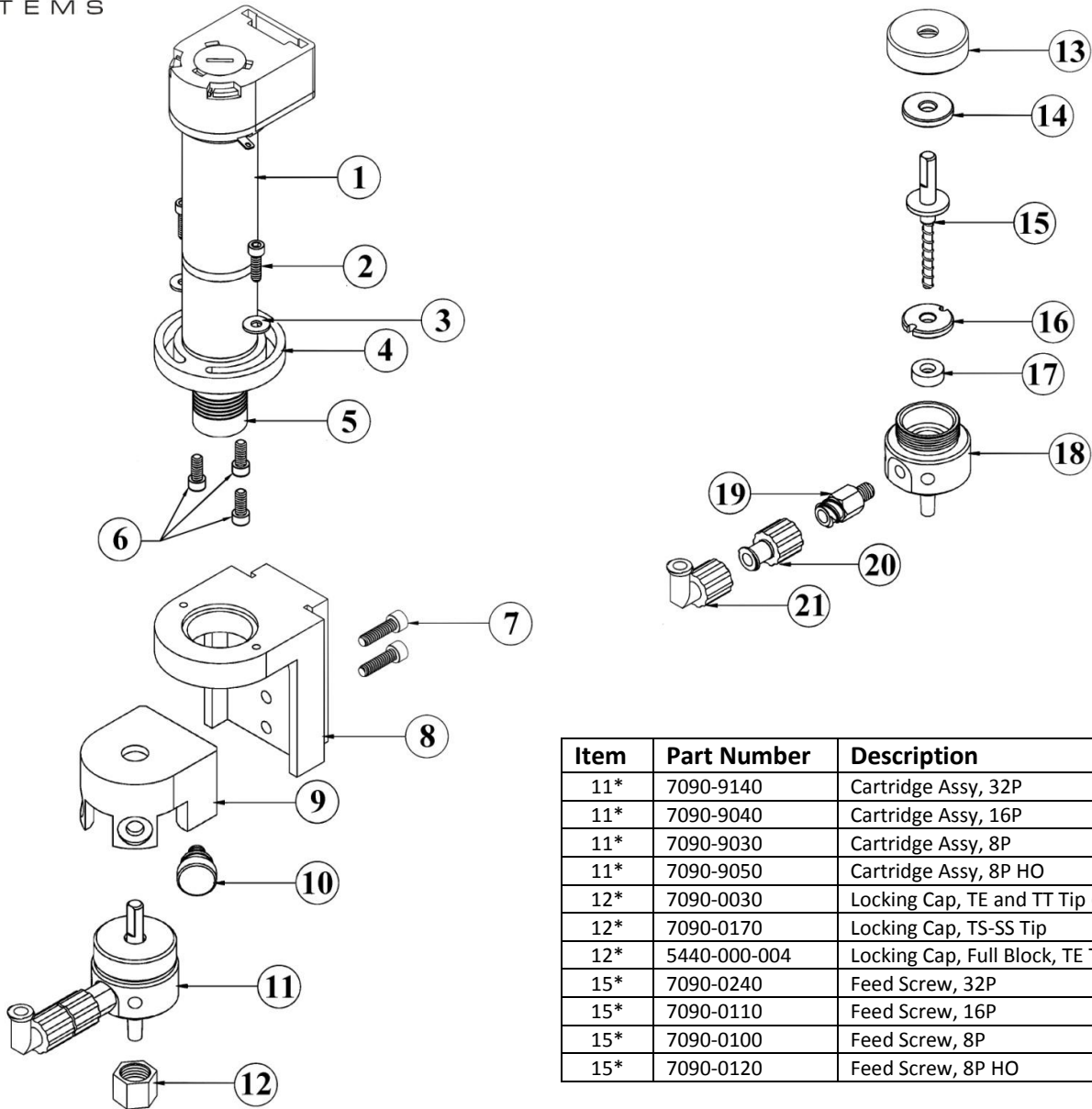

Item	Part Number	Description
11*	7090-9140	Cartridge Assy, 32P
11*	7090-9040	Cartridge Assy, 16P
11*	7090-9030	Cartridge Assy, 8P
11*	7090-9050	Cartridge Assy, 8P HO
12*	7090-0030	Locking Cap, TE and TT Tip (STD)
12*	7090-0170	Locking Cap, TS-SS Tip
12*	5440-000-004	Locking Cap, Full Block, TE Tip
15*	7090-0240	Feed Screw, 32P
15*	7090-0110	Feed Screw, 16P
15*	7090-0100	Feed Screw, 8P
15*	7090-0120	Feed Screw, 8P HO

Lubrication: No lubrication required on valve but conditioning cream (7105XCON = 10cc, 7305XCON = 30cc or TS60C-CON = 177cc) should be used, after repair, to prime the valve before production use.

Item	Part Number	Description	Item	Part Number	Description
1	TSD1412-22	Motor, 6W, No Encoder	12	SEE CHART	Tip Cap
1*	TSD1412-31	Motor 6W, With Encoder	13	7090-0090	Cover
2	2800-0423	Mounting Plate Screw	14	7090-0130	Top Thrust Washer
3	TSD1109-1	Mounting Plate Washer	15	SEE CHART	Feed Screw
4	7090-0060	Motor Mounting Plate	16	7090-0140	Bottom Thrust Washer
5	7090-0050	Coupling	17	3300-0353	U-Cup Seal
6	TSD1103-330	Mounting Plate Screw	18	7090-0070	Cartridge Body, 32P, 16P and 8P STD
7	2800-0213	Main Housing Screw	18*	7090-0080	Cartridge Body, 8P High Output
8	7090-0010	Main Housing	19	TSD931-63	Luer Lock Adaptor, Stainless Steel
9	7090-0020	Cartridge Housing	20	TSD931-82	Luer Lock Adaptor, Nylon
10	7090-0040	Thumb Screw	21	TSD931-81	Luer Lock Elbow Adaptor, Nylon
11	SEE CHART	Cartridge Assy			